

6/4 Warrender Park Terrace, Edinburgh, EH9 1JA

No expense has been spared in this beautiful B listed Victorian Flat. Positioned on the second floor, enjoying picturesque views overlooking the park, providing a serene backdrop that complements urban living. This beautifully curated three bedroom flat is the epitome of sophistication and style.



3



2





Thoughtfully finished throughout with a quiet elegance.

- B listed Victorian Flat
- 3 double bedrooms
- House bathroom & en-suite
- Renovated in 2021 including new plumbing & rewire
- Picturesque views overlooking the park
- Second floor
- Effortlessly styled
- Period features throughout
- Impeccably maintained
- High quality kitchen

6/4 Warrender Park Terrace, Edinburgh, EH9 1JA

**Warrender Park Terrace,
Edinburgh, EH9 1JA**



Approx. Gross Internal Area
120.31 Sq M - 1295 Sq Ft
For identification only. Not to scale.
© SquareFoot 2025

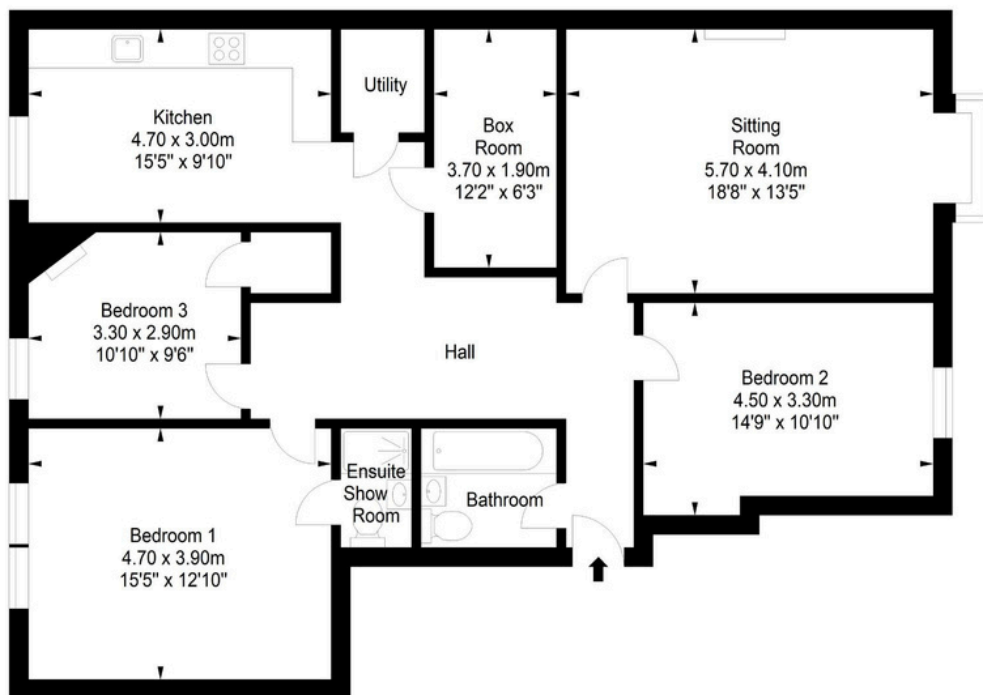
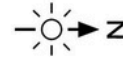

Second Floor

Illustration for identification purposes only, measurements are approximate, not to scale

**To arrange a viewing, call
+44(0)131 287 5500 or email us
at hello@niksenproperty.com**