

34/7 Learmonth Grove Edinburgh EH4 1BW

This refurbished 2 double bedroom apartment is the ultimate spot for anyone looking to soak up the unique Stockbridge vibe whilst having easy access to Inverleith park. With a west-facing front aspect, the flat is a constant wash of natural light, keeping things bright and airy all day long. High ceilings, large windows, and original details give it a warm, welcoming feel, while the recent updates make it a comfortable and stylish place to live.



2



1





Bright, refurbished gem

- Brand new kitchen
- 2 Double bedrooms
- Communal garden
- Recently refurbished throughout
- Incredible views
- Awash with natural light
- Sought-after neighbourhood
- Close to cafes, restaurants, bars and boutiques

34/7 Learmonth Grove, Edinburgh, EH4 1BW

Learmonth Grove,
Edinburgh,
Midlothian, EH4 1BW



Approx. Gross Internal Area
726 Sq Ft - 67.45 Sq M
For identification only. Not to scale.
© SquareFoot 2024

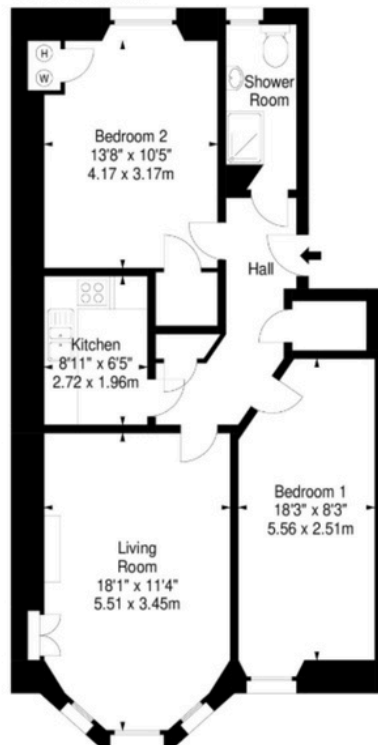

Illustration for identification purposes only, measurements are approximate, not to scale

To arrange a viewing, call
+44(0)131 287 5500 or email us
at **hello@niksenproperty.com**